

# SABAL PALM NORTH

## SABAL PALMS CDD

### CITY OF TAMARAC, BROWARD COUNTY, FLORIDA

#### LEGEND

	TYPE 'C' INLET
	M.H.
	90' - 15" R.C.P.
	RIDGE LINE
	1% PAVEMENT SLOPE AND DIRECTION
	DIRECTION OF OVERLAND FLOW PROPOSED GRADE
	EXISTING GRADE
	FINISHED FLOOR ELEVATION
	CONCRETE SIDEWALK
	EXISTING UTILITIES OR UTILITIES BY OTHERS
	PROPOSED CONCRETE
	PROPOSED ASPHALT PAVEMENT
	POLLUTION RETARDANT BAFFLE
	BLUE REFLECTOR
	UTILITY EASEMENT
	D.W.E.
	EXISTING GATE VALVE AND FIRE HYDRANT
	DOUBLE WATER SERVICE
	SINGLE WATER SERVICE
	FIRE HYDRANT AND GATE VALVE
	BACTERIOLOGICAL SAMPLING POINT
	W.M.
	G.V.
	F.H.
	R.P.Z.
	4" DIA. MANHOLE
	R.E.
	I.E.
	SINGLE SEWER SERVICE
	DIRECTION OF SANITARY SEWER FLOW
	R/W LINE
	PROPERTY LINE
	EXISTING ELEVATION
	EXISTING CONCRETE POWER POLE
	EXISTING WOOD POLE

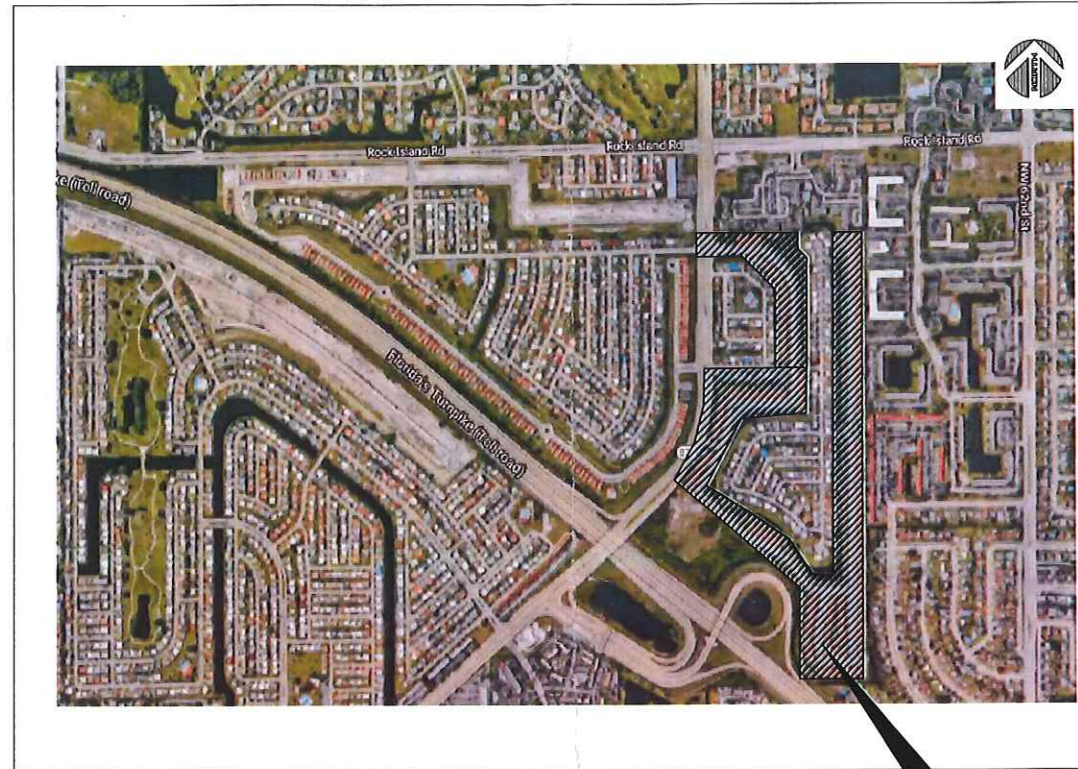

LOCATION MAP

SCALE: NTS

PROJECT LOCATION



2737 Northeast 30th Place  
Fort Lauderdale, Florida 33306  
Phone: (954) 491-7811  
Authorization No. EB-26343



#### INDEX OF SHEETS:

DESCRIPTION:	SHEET NO.:
COVER SHEET	1
CDD MAINTENANCE	2-3

"THE PROPOSED WORK HAS BEEN DESIGNED IN ACCORDANCE WITH ALL APPLICABLE FEDERAL, STATE, COUNTY, AND CITY OF TAMARAC CODES AND REGULATIONS HAVING JURISDICTION. IF ANY DISCREPANCIES EXIST BETWEEN THE PLANS/SPECIFICATION PREPARED BY THE DESIGNER AND THE CITY OF TAMARAC CODE AND/OR THE CITY OF TAMARAC STANDARD DETAILS, THE LATER SHALL GOVERN OR THE MOST STRINGENT."

ALL ROADS WITHIN THIS DEVELOPMENT ARE PRIVATE AND MAINTAINED BY THE HOME OWNERS ASSOCIATION

# CDD MAINTENANCE PLAN

Engineer of Record S/N: 95 80 00 32 E4 4C 14 A6 37 98	CARLOS J. BALLBE	Project Number: 201526
Registered Engineer Number: State of Florida	4181	Date: 03/21/2019 Sheet Number: 1

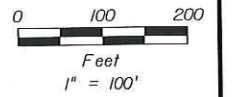

LEGEND:

- TRACT C, D B E
- TRACT B-6 THROUGH B-10, B-13
- TRACT C-3 B C-4 CANAL
- TRACT C-3 B C-4 LANDSCAPE
- TRACT R-4
- TRACT I, J, K, M, N, P, Q, S,
- TRACT G
- TRACT H
- TRACT F THROUGH F-4

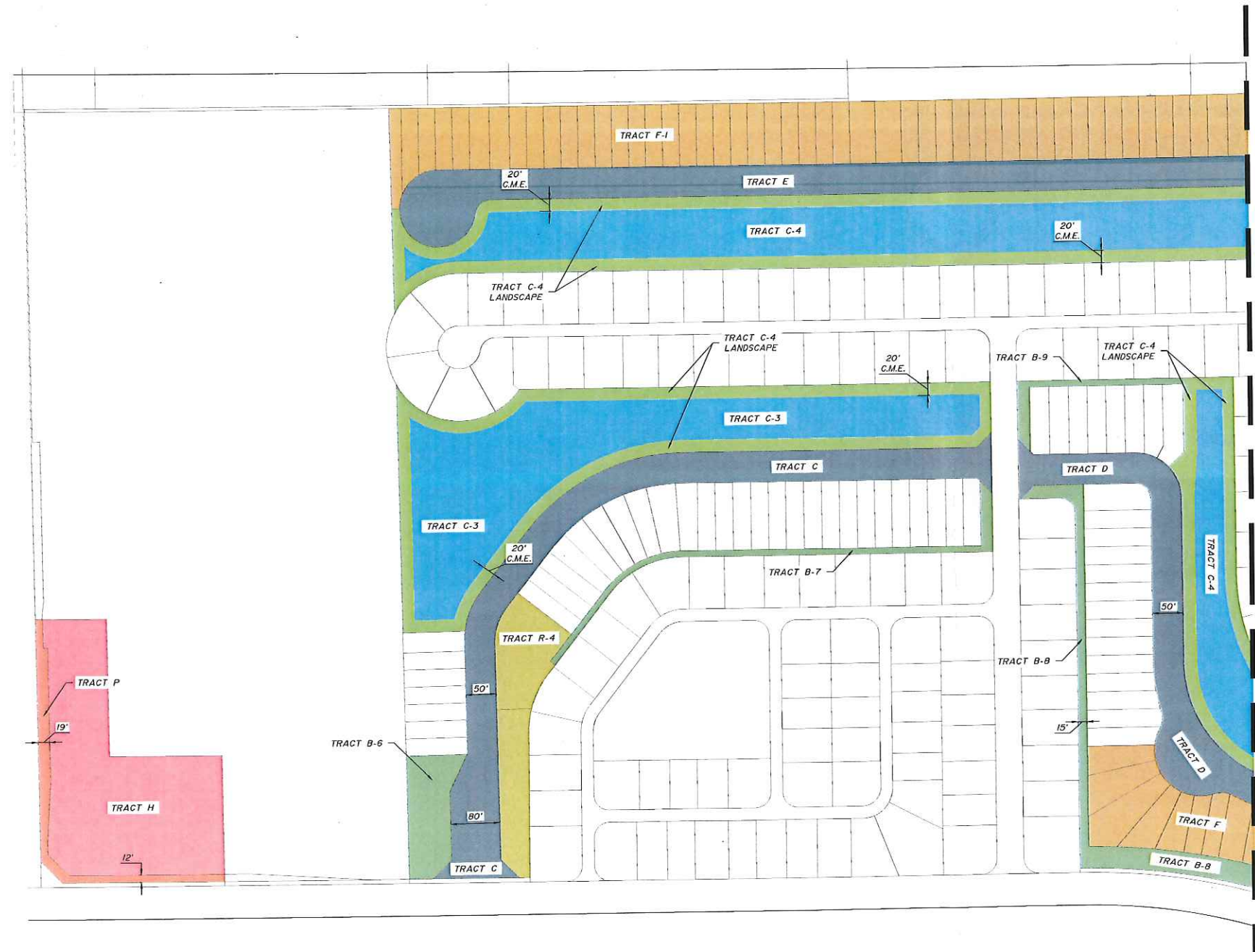
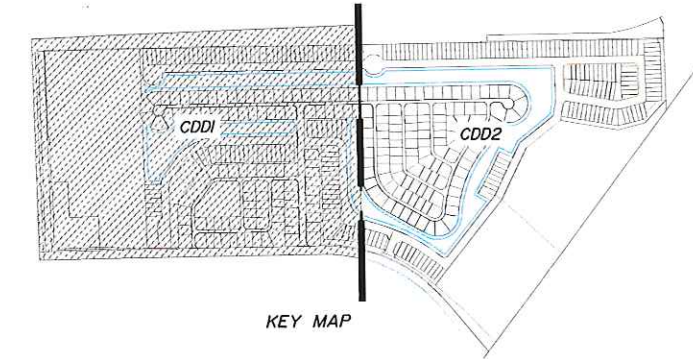

MATCHLINE REFER TO CDD(2)

NO.	DATE	BY	REVISION	NO.	DATE	BY	REVISION

Designed by: N.G.T. Date: 02/20/19  
 Drawn by: N.G.T. Date: 02/20/19  
 Checked by: C.J.B. Date: \_\_\_\_\_

**BALLBÉ & ASSOCIATES**  
 Civil Engineering • Planning • Surveying

2737 Northeast 30th Place  
 Fort Lauderdale, Florida 33306  
 Phone: (954) 491-7811  
 Authorization No. EB-26343

Engineer of Record: CARLOS J. BALLBÉ  
 Registered Engineer Number: 4181  
 State of Florida

**CDD MAINTENANCE PLAN**  
**SABAL PALM NORTH**  
 SABAL PALMS CDD

Project Number: 201526  
 Sheet Number: 2

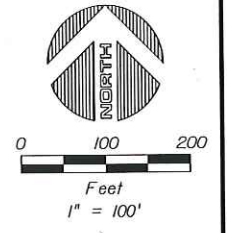

LEGEND:

- TRACT C, D & E
- TRACT B-6 THROUGH B-10, B-13
- TRACT C-3 & C-4 CANAL
- TRACT C-3 & C-4 LANDSCAPE
- TRACT R-4
- TRACT I, J, K, M, N, P, Q, S,
- TRACT G
- TRACT H
- TRACT F THROUGH F-4

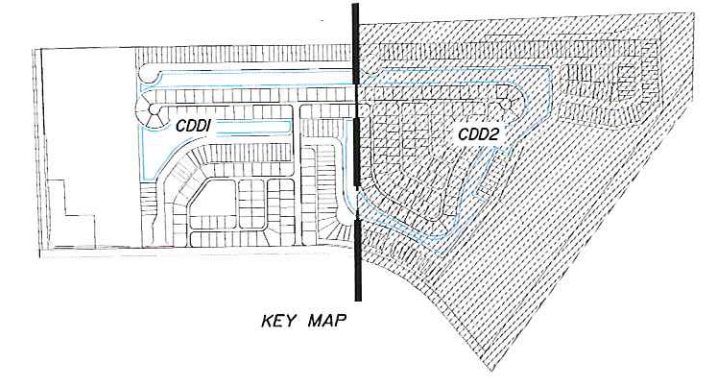

NO.	DATE	BY	REVISION	NO.	DATE	BY	REVISION

Designed by: N.G.T. Date: 02/2019  
 Drawn by: N.G.T. Date: 02/2019  
 Checked by: C.J.B. Date: \_\_\_\_\_

**BALLBÉ & ASSOCIATES**  
 Civil Engineering • Planning • Surveying

2737 Northeast 30th Place  
 Fort Lauderdale, Florida 33306  
 Phone: (954) 491-7811  
 Authorization No. EB-26343

Engineer of Record: CARLOS J. BALLBÉ  
 Registered Engineer Number: 4181  
 State of Florida  
 Date: 03/22/2019

**CDD MAINTENANCE  
 PLAN**

**SABAL PALM NORTH  
 SABAL PALMS CDD**

Project Number:  
201526

Sheet Number:  
3